

Multi-Use Steam Canister

Owner's Guide

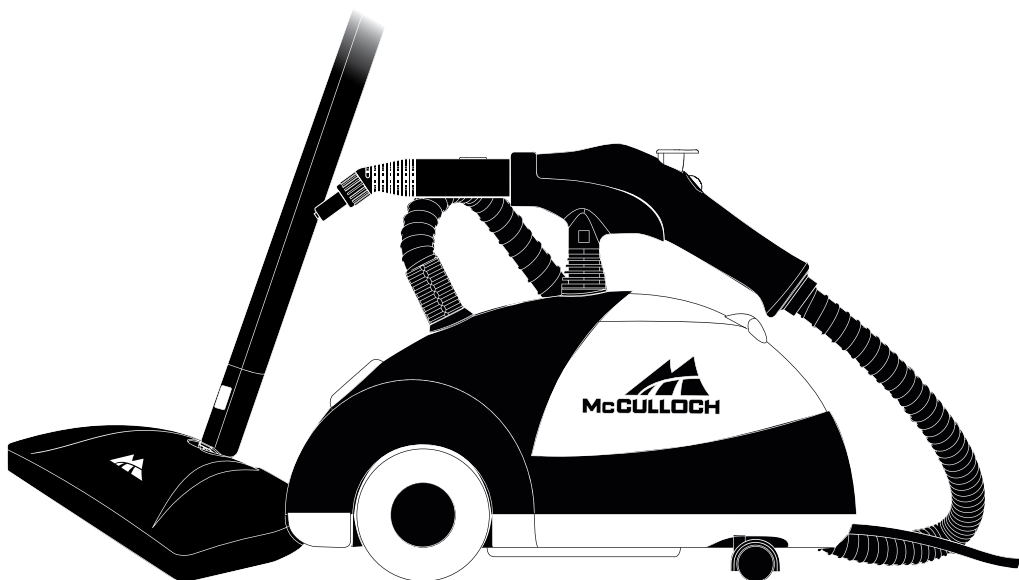

KEEP YOUR RECEIPT FOR WARRANTY PURPOSES

Please read all instructions before use.

IMPORTANT SAFETY INSTRUCTIONS

This owner's guide and any additional inserts are considered part of the product. They contain important information about safety, use, and disposal. Before using the product, please familiarize yourself with all operating and safety instructions. Please keep all documents for future reference and pass these documents on, together with the product, to any future owner. See our website for the most current version of this owner's guide.

INTENDED USE: This product is intended to be used indoors for household cleaning in the United States and/or Canada. This product is not intended for commercial or industrial use. The manufacturer assumes no responsibility for damage or injury due to unauthorized use or product modification. Failure to follow these directions will void the product warranty.

WARNING: Risk to Children and Impaired Persons

Supervision is required during the installation, operation, cleaning and maintenance of this product by children age 12 and under and anyone with reduced physical, sensory or mental capabilities. Children should be supervised to ensure that they do not play with the appliance, its parts and packaging material.

Directions to reduce risk of fire, electrical shock, and injury:

1. Read all instructions before use.
2. If an extension cord is necessary, use a properly rated cord (15 ampere, 14 gauge). Cords rated for less amperage may overheat. Use care to position extension cord where it is least likely to be damaged or tripped over during use.
3. Before plugging power cord into electrical outlet, be sure that all electrical information on rating label agrees with your power supply.
4. To reduce likelihood of circuit overload, DO NOT operate another high wattage appliance on the same circuit as this unit.
5. To reduce the risk of electric shock, do not immerse the appliance in water or other liquids. If product falls into water or another liquid, immediately unplug. Do not reach into the water while product is plugged in.
6. Do not use power cord as handle, let it hang over edges of counters, or be crimped or closed in doors.
7. Never yank power cord to disconnect from outlet; instead, grasp plug and pull to disconnect.
8. Do not operate unit with a damaged power cord or if the unit has been dropped or damaged. To avoid risk of electrical shock, do not disassemble unit; contact Vornado Consumer Service for examination and repair. Incorrect reassembly can cause a risk of electrical shock when unit is used.
9. A loose fit between wall outlet (receptacle) and plug may cause overheating and distortion of the plug. Discontinue use of the product in this outlet. Contact a qualified electrician to replace loose or worn outlets.
10. Do not leave unit unattended while plugged in. Unplug the appliance immediately after each use.
11. Do not use unit where aerosol-based products are being used, or where oxygen is being administered.
12. Unit is only meant to be used with recommended accessories. Using other types of attachments may cause damage to unit or injury.
13. If Lighted On/Off Switch does not illuminate when set to "ON" position while power cord is plugged in, unit is not operating normally. Immediately disconnect cord from power supply, then refer to troubleshooting guide of this manual for assistance.
14. Always turn unit off and unplug power cord before filling with water. Do not attempt to use unit without properly filling.
15. When filling, only water should be used in unit – other cleaning agents could damage unit or cause injury. Distilled or de-mineralized water is highly recommended, in order to minimize potential build-up of mineral deposits. Do not overfill with more than recommended amount of water.
16. To avoid burns from escaping steam when removing cap to refill unit:

- Always allow unit to cool for 5-10 minutes.
 - Press and hold Steam Button to release all remaining steam pressure.
17. To reduce risk of contact with hot water emitting from Main Nozzle, check appliance before each use by positioning it away from body and turning it on. Do not operate unit if Main Nozzle is blocked.
 18. Burns can occur from touching hot metal parts, hot water, or steam. Do not touch Main Nozzle or attempt to connect accessories while unit is in use. Do not touch bottom of Mop Head or attempt to attach a Microfiber Pad by hand while unit is in use. Use caution when you turn unit upside-down – there may be hot water.
 19. Use caution when using unit on uneven surfaces, such as stairs. Do not place, set or store the product near water, such as a bathtub or sink. Never immerse the product in liquids. Do not allow cord to touch hot surfaces.
 20. When steaming any surface for the first time, it is recommended that you consult the manufacturer's guidelines for material being steamed. For items in question, test on an inconspicuous area before proceeding.
 21. Steaming unsealed hardwood or unglazed ceramic surfaces is not recommended, and may result in warping or damage to the surface. Steam may remove the sheen from surfaces treated with wax.
 22. When steam mopping, never leave unit resting in one spot on any surface for any period of time – prolonged exposure to heat and moisture may damage floor surfaces.
 23. Do not allow power cord to touch hot surfaces during use. Bundle cord loosely when storing.
 24. Always allow unit to cool (at least 30 minutes for complete cooling) and empty before storing. Do not store unit with a damp Microfiber Pad still attached.
 25. This product is for use on 120 volt electrical outlets. The cord has a plug as shown at A in Figure 65.1. An adapter, as shown at C, can be used to connect three-blade grounding-type plugs to two-slot receptacles (it is not included with your product). The green grounding lug extending from the adapter must be connected to a permanent ground such as a properly grounded outlet box. An adapter should not be used if a three-slot grounded receptacle is available. *NOTE: A TWO-PRONG ADAPTOR IS NOT INCLUDED WITH THIS PRODUCT.

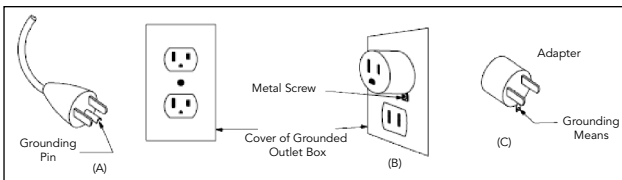

Figure 65.1

FCC CONSUMER ADVISEMENT: This equipment may generate, use and/or radiate radio frequency energy that may cause harmful interference to radio communications. If this equipment does cause harmful interference to radio or television reception, which can be determined by turning the equipment off and on, the user is encouraged to contact Vornado Consumer Service. Changes or modifications to this unit not expressly approved by the party responsible for compliance could void the user's authority to operate the product.

SAVE THESE INSTRUCTIONS

Questions or comments?

- mccullochsteam.com
- consumerservice@mccullochsteam.com
- 1-800-711-6617



The following features and accessories are included with your Multi-Use Steam Canister. Carefully inspect the packing material for all parts listed below. To obtain possible missing parts, refer to Product Support on Page 16 of this manual.

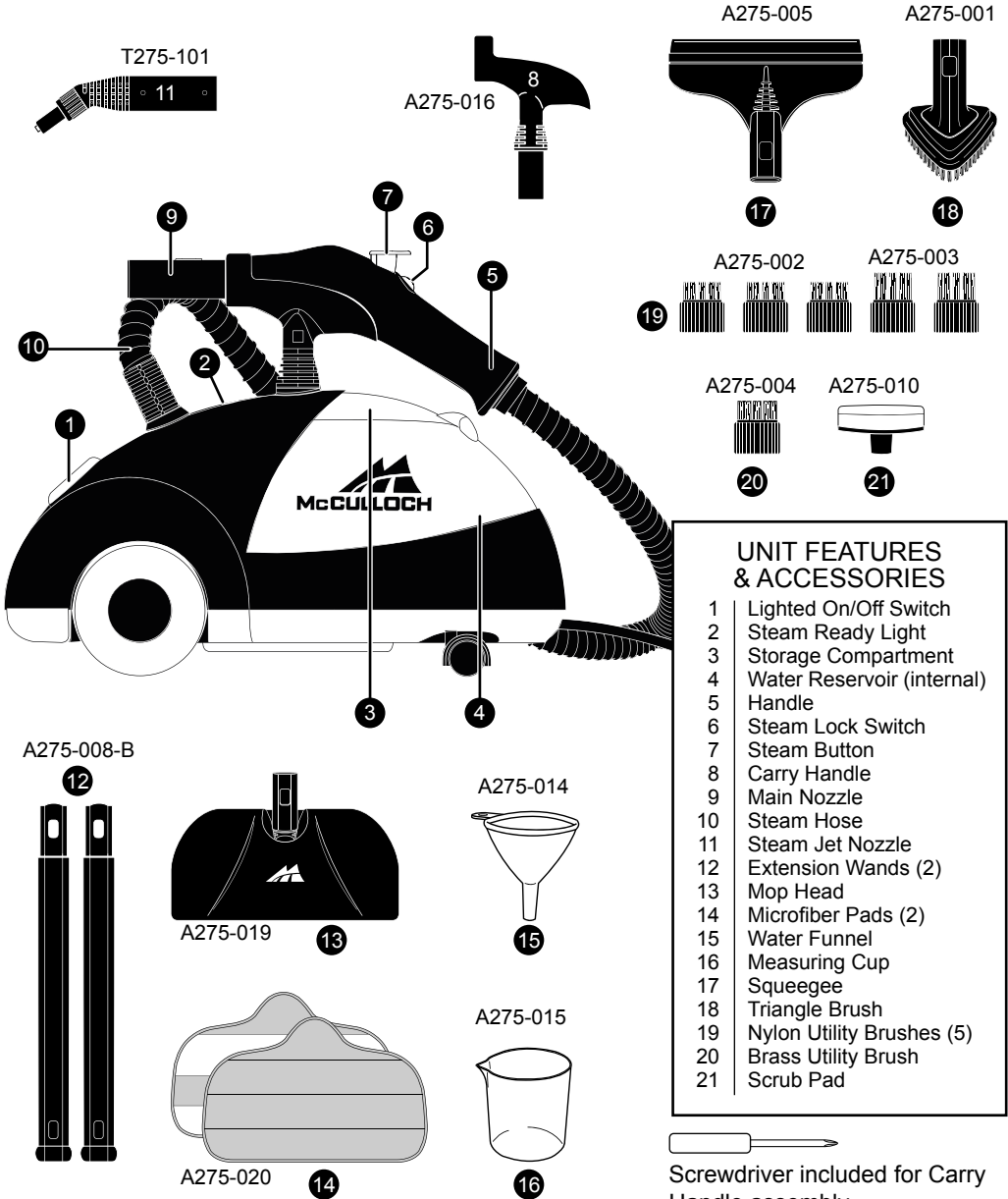

- The *Lighted On/Off Switch* (1) powers the unit On and Off.
- The *Steam Ready Light* (2) illuminates while the unit is heating, then turns off when it is ready to begin steaming. It is normal for the Steam Ready Light to go on and off during the steaming process and you can continue steaming when this occurs.
- The *Storage Compartment* (3) provides a convenient place to store small accessories; it also houses the Water Reservoir.
- The *Water Reservoir* (4) is the internal tank in which water is stored and heated. It is accessed through the Storage Compartment. There must be a sufficient amount of water in the Water Reservoir in order for the unit to function properly.
- The *Handle* (5) is designed to stay cool while providing the optimum amount of safety and user comfort.
- The *Steam Lock Switch* (6) is pushed forward to lock the Steam Button down and provide continuous steam, without continuously pressing the Steam Button.
- The *Steam Button* (7) provides full steam-on-demand control, releasing hot, penetrating steam from the Main Nozzle when pressed.
- The *Carry Handle* (8) functions as a convenient holder for the Main Nozzle, and is designed for carrying the unit.
- The *Main Nozzle* (9) emits a powerful flow of steam when the Steam Button is pressed.
- The *Steam Hose* (10) safely channels the flow of steam from the Water Reservoir to the Main Nozzle.
- The *Steam Jet Nozzle* (11) focuses the flow of steam from the Main Nozzle, and serves as the base to which the Utility Brushes and Scrub Pad connect.
- The *Extension Wands* (12) connect to the Main Nozzle. Used with mop attachment or for high or hard-to-reach places.
- The *Mop Head* (13) connects to the Extension Wands, and is designed for steam cleaning a variety of hard floor surfaces.
- The *Microfiber Pads* (14) attach to the Mop Head, and are designed for removing scuffs and stains from hard floors. The Pads are reusable and machine washable.
- The *Water Funnel* (15) and the *Measuring Cup* (16) are provided for ease in filling the Water Reservoir. The optimum amount of water is (16 - 48 oz. / 473 - 1,420 ml.).
- The *Squeegee* (17) connects to either the Main Nozzle or Extension Wands, and can be used to clean mirrors, windows and other smooth glass surfaces.
- The *Triangle Brush* (18) connects to the Main Nozzle or Extension Wands, and is designed for cleaning corners and other difficult angles.
- The assorted *Nylon Utility Brushes* (19) connect to the Steam Jet Nozzle, providing extra scrubbing power for removing exceptionally tough dirt and stains.
- The *Brass Utility Brush* (20) connects to the Steam Jet Nozzle and is designed for removing tough stuck-on grease and grime from durable surfaces such as ovens and grills.

NOTE: Use careful judgement when deciding what surface to clean with the Brass Utility Brush. Some delicate surfaces, such as stainless steel, may be scratched or damaged by the brass bristles. If you are unsure whether or not a surface will be damaged, it is recommended that you test a small inconspicuous spot before proceeding.

- The *Scrub Pad* (21) connects to the Steam Jet Nozzle and is designed to scrub tough dirt and scuffs from surfaces.

STEAM MOPPING ACCESSORIES

WARNING: Do not try to connect accessories while unit is emitting steam.

EXTENSION WANDS

1. Select one of the Extension Wands. Insert end (A) of Wand into Main Nozzle (B). Align hole in Wand with grey lock/release button on Nozzle.
2. Press down on grey lock/release button. While continuing to hold button down, slide Extension Wand onto Main Nozzle until button snaps through hole on Wand.
3. Slide remaining Extension Wand (C) onto end of assembled Wand (D), this time lining up rectangular hole of remaining Wand with grey lock/release button of first Wand. Press and hold button, and firmly push second Wand onto end of first Wand until button snaps through hole. Both Extension Wands should now be connected to the Main Nozzle.

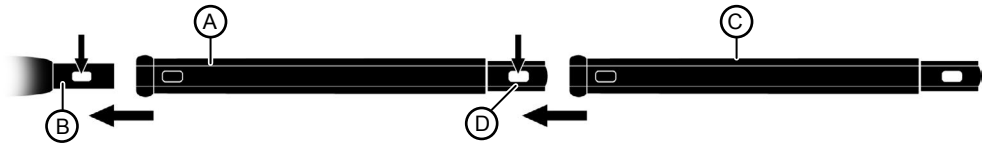

MOP HEAD

1. Align Mop Head with open end of Extension Wand, so that rectangular hole in Mop Head aligns with grey lock/release button on Wand.
2. Press down on grey lock/release button. While continuing to hold button down, slide Mop Head onto Extension Wand (See figure 1-A). Press on firmly until button snaps through hole (See figure 1-B).

NOTE: Do not use excessive force when mopping or using Extension Wands as this may cause the Wands to break.



FIGURE 1

MICROFIBER PADS

1. Lay one Microfiber Pad on flat surface, with two fastener strips facing upward.
2. Align Mop Head with Microfiber Pad. Make sure Mop Head is oriented with Pad as shown, and centered as best as possible (See figure 2-A).
3. Press Mop Head firmly down onto Microfiber Pad. Fastener strips will adhere to Pad Grips on underside of Mop Head. Pad should now be attached and ready for use (See figure 2-B).

CAUTION: Use care when handling a recently used Microfiber Pad, as it may still be hot.

NOTE: Microfiber Pads are machine washable. To avoid picking up lint, washing separately from other fabrics is recommended. Only use liquid detergent. Avoid using any fabric softeners or bleach. Air drying is recommended; machine drying on a low heat or air dry setting is acceptable as well.

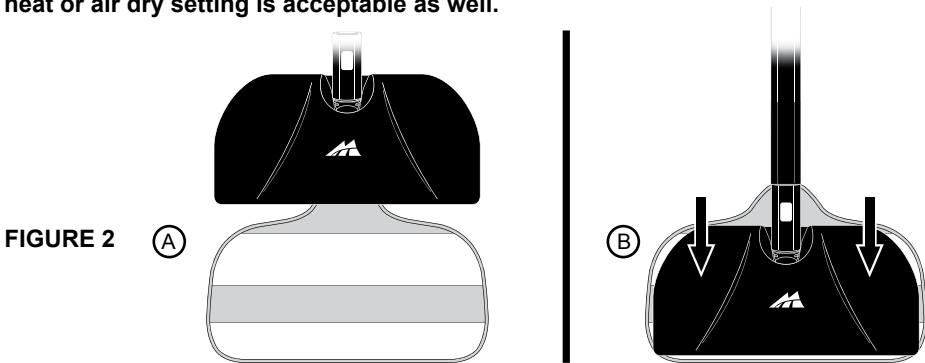

The Mop Head and Microfiber Pads are perfect for use on these hard floor surfaces:

- Sealed Hardwood
- Sealed Laminate
- Glazed Ceramic
- Marble
- Tile
- Stained Concrete
- Linoleum
- Granite
- Vinyl

IMPORTANT: Do not use on unsealed hardwood or unglazed ceramic surfaces. Surfaces that are not properly sealed may be warped or damaged by exposure to heat and moisture.

Care should also be taken when steaming sealed hardwood floors, as prolonged exposure to steam in a single spot may cause damage and discoloration. To avoid this, keep the Mop Head in constant motion on these surfaces.

Steam may remove the sheen from some floors that have been treated with wax.

Extremely rough textured floors may tear or damage Microfiber Pads.

Before steaming any flooring, it is recommended to consult the manufacturer's guidelines. For flooring in question, always test on a small inconspicuous area before proceeding.

STEAM CLEANING ACCESSORIES

WARNING: Do not connect accessories while unit is emitting steam.

STEAM JET NOZZLE / SQUEEGEE / TRIANGLE BRUSH

1. Select one of the three accessories (Steam Jet Nozzle, Squeegee or Triangle Brush – Steam Jet Nozzle shown as example), and align (A) end of accessory with Main Nozzle (B). Align hole in accessory with grey lock/release button on Nozzle.
2. Press down on grey lock/release button. While continuing to hold button down, slide accessory onto Nozzle until button snaps through rectangular hole.

NOTE: The Steam Jet Nozzle, Squeegee and Triangle Brush can be connected to the end of an Extension Wand for reaching high or difficult spots. Connect the Extension Wand (or Wands) as outlined on Page 6, then connect your desired accessory to the Wand in the same way as you would normally connect to the Main Nozzle.

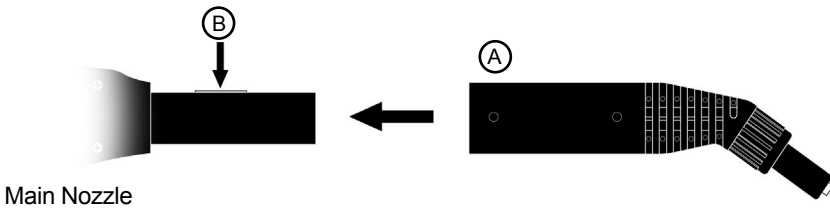

UTILITY BRUSHES

NOTE: Utility Brushes connect to the Steam Jet Nozzle, not the Main Nozzle.

1. Align guide tab on inside of Utility Brush (A) with groove on bottom of Steam Jet Nozzle tip (B).
2. Firmly press Utility Brush onto tip of Steam Jet Nozzle. Press it on as far as possible to prevent steam leakage (See figure 3-C).
3. To remove Utility Brush, simply grip it firmly and pull it off Steam Jet Nozzle.



FIGURE 3

SCRUB PAD

NOTE: Scrub Pad connects to the Steam Jet Nozzle, not the Main Nozzle.

1. Place Scrub Pad over tip of Steam Jet Nozzle, and firmly press it on to Steam Jet Nozzle as far as possible (See figure 4). This will help to prevent steam leakage.
2. To remove Scrub Pad, simply grip it firmly and pull it off of Steam Jet Nozzle.

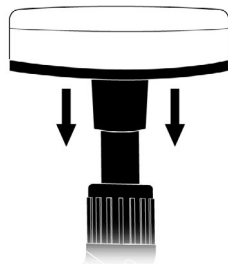

FIGURE 4

CARRY HANDLE

1. Insert Carry Handle into hole on top of unit. Align Handle so that grip bracket faces towards front of unit (See figure 5).
2. Use enclosed Screw Driver to tighten screw found inside Carry Handle, until secured to main unit.



FIGURE 5

ORDERING ACCESSORIES & PARTS

Replacement accessories and parts for your Multi-Use Steam Canister (model MC1275) may be ordered through our Website:

www.mccullochsteam.com

You may also contact Consumer Service directly:

consumerservice@mccullochsteam.com or 1-800-711-6617

Nylon Utility Brush	Ovens, stove tops, faucet fixtures, tile, grout, refrigerators, microwaves, showers, bathtubs, doorknobs, waste can, sports equipment, toys and changing tables.
Steam Jet Nozzle	Removing dirt, grease and grime from cracks and crevices. Defrosting freezers. Dirt and grass in grooves of golf clubs. Dirt and grime in tread of running shoes. Cleaning intricate precious metal and stone jewelry (not pearls or costume jewelry) CAUTION: Hot steam. Do not handle while steaming.
Traditional Microfiber Pad (Super absorbent pads for everyday use)	Vinyl, stone, slate, marble, sealed hardwood, glazed ceramic tile, granite, stained concrete, grout, linoleum, laminate, bamboo and other delicate floors.
Squeegee	Bugs on windshield. Removing soap scum and grime. Shower glass, doors, mirrors and glass.
Triangle Brush	Hard to reach corners on counter tops, bathtubs and floors.
Brass Utility Brush	BBQ grills and oven wire racks.
Scrub Pad	Stone, slate, glazed ceramic tile and grout.

WARNING: Do not use on unsealed floors or unglazed ceramic floors. Always test in inconspicuous area before use.

FILLING WATER RESERVOIR

1. Place Multi-Use Steam Canister on a flat, level surface.
2. Make sure Lighted On/Off Switch is turned to “Off” and grounded power cord is unplugged from electrical outlet.



If unit has been in use, always use the following safety precautions before removing the Water Reservoir cap to add water:

- Allow unit to cool for 20 minutes.
- Press and hold Steam Button to release **ALL** remaining steam.

WARNING: Failure to follow these precautions may result in burns from escaping steam when the Water Reservoir cap is removed.

3. Flip Storage Compartment lid open, and cautiously unscrew and remove Water Reservoir cap.
4. Drain any water remaining inside Water Reservoir.

NOTE: Water Reservoir should be emptied after each use – this will help minimize mineral build-up and prevent over-filling.

5. Fill Measuring Cup to maximum fill line (16 oz. / 473 ml.) with water.

NOTE: In order to significantly reduce mineral build-up and prolong the life of your Multi-Use Steam Canister, use of distilled or de-mineralized water in the unit is highly recommended. Refer to Page 14 for more information about mineral build-up.

6. Insert Water Funnel into fill hole and carefully pour water from Measuring Cup into Water Reservoir.

WARNING: Caution should always be used when pouring water into the Water Reservoir. Do not look directly down into fill hole when filling. Keep your free hand and any children or pets at a safe distance.

7. Depending on how long you intend to steam, you may repeat steps 5 & 6 up to two more times, up to a maximum of 48 oz. (1,420 ml.) of water. See chart for a comparison of the amount of water vs. approximate steam time.

Amount of Water	Duration of Steam
16 oz. (473 ml.)	Approximately 15 min.
32 oz. (946 ml.)	Approximately 30 min.
48 oz. (1420 ml.)	Approximately 45 min.

8. Replace Water Reservoir cap, ensuring that it is screwed on tightly to prevent hot steam from escaping and causing injury.
9. Close Storage Compartment lid.

GENERAL OPERATION

NOTE: Be sure that Water Reservoir has been filled and that all desired accessories are connected before following these steps.

1. For first time use, remove protective plastic cover from electrical plug. Plug power cord into a electrical outlet.
2. Switch Lighted On/Off Switch to “On” position. Steam Ready Light will immediately illuminate, indicating that unit is heating.
3. Steam Ready Light will turn off in 2-8 minutes (depending on how much water is in Water Reservoir), indicating that unit is fully heated and ready to begin steaming.
4. Direct Nozzle (and any connected accessory) towards surface you desire to steam, and press Steam Button.

CAUTION: Always be sure that Nozzle and any accessory are pointed in a safe direction (away from yourself, other people, pets, and plants) before pressing Steam Button.

5. Keep Steam Button pressed for a continuous flow of steam. You may also slide the Steam Lock Switch forward while pressing the Steam Button to lock it down. This will allow a continuous flow of steam without need of holding the Button down manually.
6. Using a back-and-forth motion over the area you are steaming will further enhance the cleaning process. Wipe steamed areas with a clean cloth to remove loosened dirt and grime. Wiping the area while it is still wet is recommended, but use caution when wiping surfaces such as metal that may still be hot.

NOTE: During use, the Steam Ready Light may illuminate. This is normal. If you notice a drop in steam pressure, release Steam Button until Steam Ready Light turns off again.

7. Once steaming tasks are complete, turn the unit “Off” and unplug. Follow steps under Proper Storage procedure on Page 14 of this manual.

STEAM MOPPING

NOTE: Be sure that Water Reservoir has been filled and that all steam mopping accessories are connected before following these steps.

It is recommended to sweep or vacuum hard floors before mopping.

1. Follow Steps 1-3 of General Operation section above.

Refer to Page 7 for a listing of hard floor surfaces that are recommended for cleaning with the Multi-Use Steam Canister.

2. For best results, use a continuous back-and-forth motion over floor surface, pushing the Mop Head away and pulling it back towards you. Work your way backwards over the floor, in order to avoid walking over freshly mopped areas.

NOTE: To avoid warping or damage caused by heat and moisture, do not use on unsealed hardwood or unglazed ceramic surfaces. Steam may remove the sheen from some floors that have been treated with wax.

3. The Microfiber Pad will absorb dirt and moisture during mopping. However, when you are finished you may find some residual moisture has been left behind. In this case, it is recommended to allow floor time to air-dry. A fan may be directed towards mopped area to facilitate drying.

PROPER STORAGE

Preparing your Multi-Use Steam Canister for storage is quick and simple. When you have finished your steaming tasks, follow the steps listed below.

1. Turn unit “Off” and unplug power cord.
2. Allow unit to completely cool (at least 30 minutes).
3. Press and hold Steam Button to release all remaining steam.
4. Remove all accessories from unit.
5. Flip Storage Compartment lid open and remove Water Reservoir cap.
6. Drain any remaining water from Water Reservoir into a sink or tub – this will help to minimize mineral build-up and prevent over-filling during your next use. Replace Water Reservoir cap.
7. Store accessories. Utility Brushes can be conveniently stored in the Storage Compartment.
8. Close Storage Compartment lid and store Multi-Use Steam Canister in a cool, dry location.

MINERAL BUILD-UP

A common maintenance need for steam appliances is the removal of build-up caused by high mineral content in many municipal water supplies. This mineral build-up may limit the effectiveness and reduce the life of your Multi-Use Steam Canister.

The best way to minimize mineral build-up is to use distilled or de-mineralized water when using your Multi-Use Steam Canister. If you are unable to use distilled water, it is recommended that the following procedure be followed monthly to remove any mineral build-up:

1. Turn unit “Off” and unplug power cord.
2. Allow unit to completely cool (at least 30 minutes).
3. Press and hold Steam Button to release all remaining steam.
4. Remove all accessories from unit.
5. Flip up Storage Compartment lid and remove Water Reservoir cap.
6. Drain water from Water Reservoir into a sink or tub.
7. Using Measuring Cup, make a mixture of 8 oz. (237 ml.) vinegar and 8 oz. (237 ml.) water.
8. Using the Funnel, slowly pour water-vinegar solution into Water Reservoir.
9. Allow to stand for 40 minutes.
10. Drain water-vinegar solution from Water Reservoir.
11. Rinse Water Reservoir with fresh water, drain and repeat until vinegar odor dissipates.
12. Replace Water Reservoir cap and close Storage Compartment lid.

PROBLEM	POSSIBLE CAUSE	SOLUTION
Unit fails to heat up. Lighted On/ Off Switch DOES NOT illuminate when set to "ON" position.	Unit is not plugged in.	Plug power cord into electrical outlet.
	Household circuit breaker / ground fault interrupter has tripped or blown a fuse.	Reset circuit breaker / ground fault interrupter, or replace fuse. If you need assistance, contact a licensed electrician.
	Unit is damaged or otherwise in need of repair.	Immediately cease usage and unplug. Contact Consumer Service for further assistance (see Page 16 for details).
Unit fails to heat up. Lighted On/ Off Switch DOES illuminate when set to "ON" position.	Water Reservoir is empty.	Refer to Filling Water Reservoir procedure on Page 11.
	Mineral build-up in unit.	Refer to Mineral Build-up section on Page 14 for cleaning procedure.
	Unit is damaged or otherwise in need of repair.	Immediately cease usage and unplug. Contact Consumer Service for further assistance (see Page 16 for details).
Steam output is weak or intermittent.	Water level in Water Reservoir is running low.	Refer to Filling Water Reservoir procedure on Page 11.
	Mineral build-up in unit.	Refer to Mineral Build-up section on Page 14 for cleaning procedure.
Excessive amount of water in steam. NOTE: Unit produces wet steam – it is normal for steam to contain some amount of water.	Water condensation in Steam Hose.	Point nozzle towards sink, tub or ground and shake while pressing Steam Button. Continue until excess water is released.
	Water Reservoir has been overfilled.	Filling Water Reservoir with more than 48 oz. (1,420 ml.) of water interferes with steam production, resulting in water condensation in steam. Always use included Measuring Cup to fill unit with correct amount of water. (see Page 11 for details)
	Unit has not heated to full operating temperature.	Wait until Steam Ready Light turns off to begin steaming.
Accessories do not stay firmly connected to Main Nozzle.	Accessories not properly installed.	Check to make sure that accessories are properly connected, per procedures on Pages 6-9.
Floor surfaces appear cloudy or streaky after steaming.	Microfiber Pad is dirty.	Replace Microfiber Pad with a clean one.
	Hard water residue on floor.	Switch to distilled or de-mineralized water.

Manufactured by Vornado Air, LLC, under license from Husqvarna AB (publ). McCulloch warrants to the original consumer or purchaser this McCulloch ("Product") is free from defects in material or workmanship for a period of two (2) years from the date of purchase. If any such defect is discovered within the warranty period, Vornado, at its discretion, will repair or replace the Product at no cost.

For warranty service: Call 1-800-711-6617 or email consumerservice@mccullochsteam.com to obtain a Return Authorization ("RA"). Please have or include your Product's model number and serial number, as well as your name, address, city, state, Zip code, email, and phone number when contacting Vornado for warranty service. To file a contactless warranty claim, visit www.mccullochsteam.com/contact

After receiving the RA, ship your Product to: Vornado Air LLC Attn: Warranty & Repair 415 East 13th Street, Andover, KS 67002. For your convenience, please have your model number and serial number when contacting Vornado with service inquiries. To ensure proper handling, packages must be clearly marked with the RA number. Packages not clearly marked with the RA number may be refused at the receiving dock. Please allow 2–3 weeks for warranty service and return of your Product after the Product is received.

This warranty does not apply to defects resulting from abuse of the Product, modification, alteration, mishandling, improper maintenance, commercial use or repair or service of the Product by anyone other than Vornado; damages which occur in shipment or are attributed to acts of God. Improper product use, which includes using an external device that alters or converts the voltage or frequency of electricity, or shipping a Vornado product to a country not intended for use will void all warranties. Any unauthorized product modification, repair by unauthorized repair center or use of non-approved replacement parts is not recommended and any consequences will not be covered by support services or product warranties.

The product warranty will be honored only on models that are being used in the country intended. REPAIR OR REPLACEMENT AS PROVIDED UNDER THIS WARRANTY IS THE EXCLUSIVE REMEDY OF THE CONSUMER. VORNADO SHALL NOT BE LIABLE FOR ANY INCIDENTAL OR CONSEQUENTIAL DAMAGES FOR BREACH OF ANY EXPRESS OR IMPLIED WARRANTY ON THIS PRODUCT. EXCEPT TO THE EXTENT PROHIBITED BY APPLICABLE LAW, ANY IMPLIED WARRANTY OF MERCHANTABILITY OR FITNESS FOR A PARTICULAR PURPOSE ON THIS PRODUCT IS LIMITED IN DURATION TO THE DURATION OF THIS WARRANTY. Some states do not allow the exclusion or limitation of incidental or consequential damages, or allow limitations on how long an implied warranty lasts, so the above limitations or exclusions may not apply to you. This warranty gives you specific legal rights, and you may have other rights that vary from state to state. The manufacturer assumes no responsibility for damage or injury caused by failure to follow these instructions, improper product use or unauthorized product modifications. Any such actions will invalidate the product warranty.

All company names and product names are trademarks of their respective owners. ©All rights reserved. All technical information, data and instructions for the installation, connection and operation contained in these instructions for use correspond to the latest available information at time of printing. The contents of this manual may differ slightly from the actual product. Observe any additional supplements.

© 2024 Vornado Air, LLC. Andover, KS 67002, U.S. Specifications subject to change without notice. Manufactured by Vornado Air, LLC, under license from Husqvarna AB (publ). Manufactured in China.



review this product online

www.mccullochsteam.com/reviews

Manufactured by Vornado Air LLC under license from Husqvarna AB (publ).

For more information on other McCulloch products,
visit www.mcculloch.com

For questions, or comments or warranty information,
call 1-800-711-6617 or visit www.mccullochsteam.com