

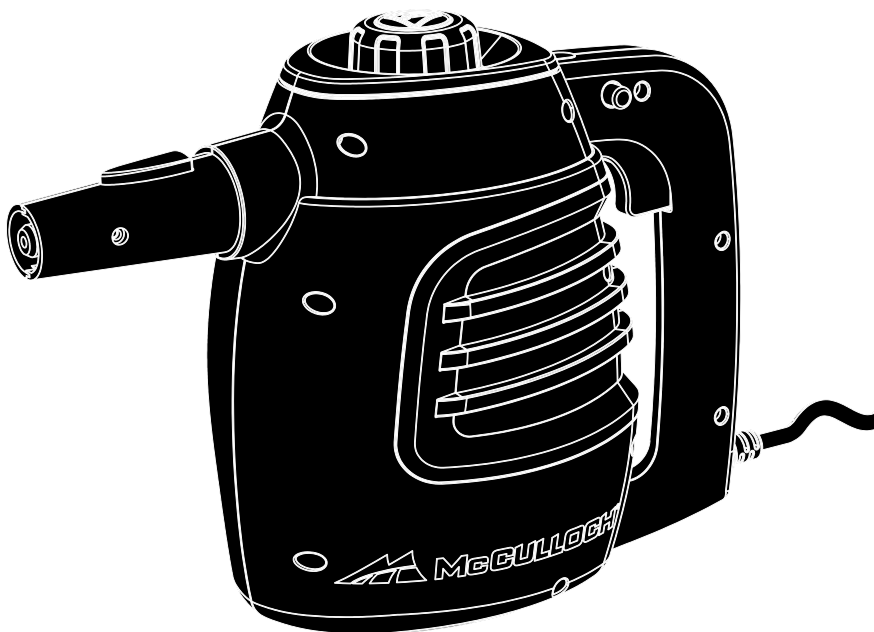

Model MC1230

Handheld Steam Cleaner

Owner's Guide



KEEP YOUR RECEIPT FOR WARRANTY PURPOSES

Please read all instructions before use.

IMPORTANT SAFETY INSTRUCTIONS



WARNING: To reduce the risk of fire, electrical shock, or injury, the following basic safety precautions should always be followed when using an electrical appliance.

READ ALL INSTRUCTIONS BEFORE USE

1. The Handheld Steam Cleaner Water Tank is designed to hold a maximum of 6 oz. (177 ml.) of water. Unplug electrical cord before filling with water.
2. DO NOT leave your Handheld Steam Cleaner unattended when plugged in or not in use. Use only for its intended purpose as indicated in this manual.
3. This unit is not a toy. Close supervision is required when using unit near children, pets, and plants. Steam produced by unit is hot and pressurized. Care must be taken to avoid burns or other injuries. Never point nozzle at people or pets.
4. To reduce the risk of contact with hot water emitting from steam vents, hold appliance away from body and check for signs of condensation or leakage.
5. DO NOT use this unit if electrical cord or outlet is damaged. DO NOT use unit if it is not working properly or has been dropped, damaged or left outdoors. If such damage occurs, DO NOT disassemble or attempt repairs, take unit to a qualified service person for examination and repair. Incorrect reassembly or repair could cause a risk of fire, electrical shock, or injury to persons when steam cleaner is used.
6. To reduce risk of electrical shock, DO NOT immerse in water or other liquids. DO NOT use electrical cord as a handle. DO NOT allow cord to be crimped by closing it in doors. DO NOT pull or stretch cord around sharp corners or edges.
7. Do not allow cord to touch hot surfaces. Let appliance cool completely before putting away. Loop cord loosely around appliance when storing.
8. DO NOT use this unit with extension cords or electrical outlets that have inadequate current capacity. A three-prong outlet or a properly grounded adapter is necessary when using Handheld Steam Cleaner.
9. In order to unplug Handheld Steam Cleaner, grasp plug and pull smoothly and firmly from outlet. DO NOT attempt to unplug unit by pulling or tugging on cord.
10. Use caution, as burns could occur from touching hot metal parts, hot water or steam.

IMPORTANT SAFETY INSTRUCTIONS



WARNING: To reduce the risk of electrical shock, this appliance has a three-pronged plug. This plug will fit in a polarized wall outlet only one way. If the plug does not fit fully in the outlet, contact a licensed electrician to install a proper outlet. DO NOT attempt to modify the plug or defeat this safety feature.

11. The Handheld Steam Cleaner is only meant to be used with recommended Handheld Steam Cleaner accessories. Other types of attachments are not to be used with the Handheld Steam Cleaner. Doing so may cause injuries or damage to unit.
12. Attachments become hot during use. To avoid injuries, DO NOT touch attachments while using this appliance. DO NOT attempt to change attachments while unit is emitting steam.
13. When filling your Handheld Steam Cleaner, only water should be used in unit. Other cleaning agents will damage unit and can cause injuries.
14. DO NOT operate unit if steam opening is blocked. Should this occur, immediately cease usage and unplug from electrical outlet.
15. Store your Handheld Steam Cleaner in a cool, dry place.
16. To avoid burns from escaping steam when removing Reservoir cap to refill unit:
 - Always allow unit to cool for 20 minutes.
 - Press and hold Steam Trigger to release ALL remaining steam.

SAVE THESE INSTRUCTIONS FOR HOUSEHOLD USE ONLY

Questions or comments?

- www.mccullochsteam.com
- consumerservice@mccullochsteam.com
- 1-800-711-6617

These features and accessories are included with your Handheld Steam Cleaner. To obtain additional parts, refer to Product Support on Page 16 of this manual.

UNIT FEATURES

- 1 Reservoir Cap
- 2 Steam Trigger
- 3 Steam Trigger Lock
- 4 15' Power Cord
- 5 Steam Nozzle
- 6 Steam Indicator Light
- 7 On/Off Switch

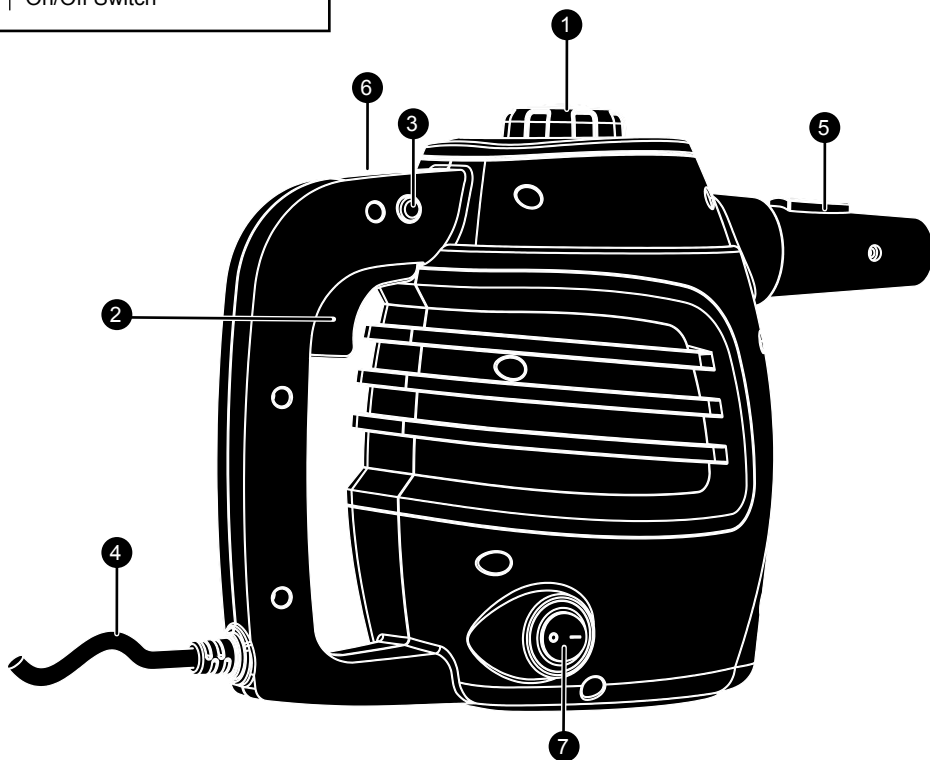

- The *Reservoir Cap* (1) is designed to safely contain steam inside the Reservoir. The Reservoir Cap must be unscrewed and removed in order to fill the Reservoir with water.
- The *Steam Trigger* (2) must be pressed in order to start the flow of steam from the Steam Nozzle.
- The *Steam Trigger Lock* (3) locks the Steam Trigger for continuous steam.
- The *15' Power Cord* (4) conveniently helps to reach all your cleaning tasks.
- The *Steam Nozzle* (5) emits a flow of hot, penetrating steam when the Steam Trigger is activated.
- The *Steam Indicator Light* (6) illuminates green once steamer has reached the amount of pressure which is required to operate, indicating it is ready for use. During use, the light may turn Red, indicating the steamer is recovering the necessary pressure. Unit can be used at a lower pressure.
- The *On/Off Switch* (7) powers the unit On or Off.



ACCESSORIES

- | | |
|----|------------------------------|
| 1 | 5.5" Jet Nozzle |
| 2 | 4" Triangle Brush |
| 3 | 6"x 4.5" Large Brush |
| 4 | 34" Extension Hose |
| 5 | 3" Scraper |
| 6 | Storage Bag |
| 7 | Fill Cup |
| 8 | 1 - 2.5" Round Scrub Pad |
| 9 | 2 - 1.5" Nylon Utility Brush |
| 10 | 1 - 1.5" Brass Utility Brush |

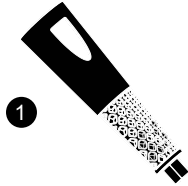

5.5" Jet Nozzle
A1230-001

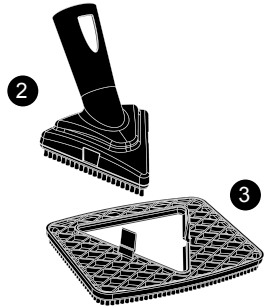

4" Triangle Brush
A1230-002

6" x 4.5" Large Brush
A1230-003

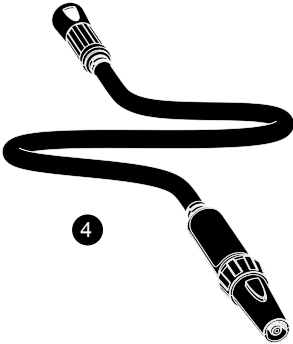

34" Extension Hose
A1230-004

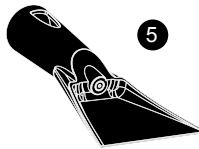

3" Scraper
A1230-009



Storage Bag
A1230-010



Fill Cup
A1230-008



2.5" Round Scrub Pad
A1230-007



1.5" Nylon Utility Brushes
A1230-005



1.5" Brass Utility Brush
A1230-006

- The *5.5" Jet Nozzle* (1) connects to the Steam Nozzle and is designed to focus the flow of steam for concentrated cleaning. The Nylon Utility Brush, Brass Utility Brush and Round Scrub Pad all connect to the Jet Nozzle. Alternatively, the Jet Nozzle may be connected to the end of the Extension Hose.
- The *4" Triangle Brush* (2) connects to the Steam Nozzle or Extension Hose, and is designed for cleaning corners and other difficult angles.
- The *6" X 4.5" Large Brush* (3) attaches to the Triangle Brush to cover large surfaces.
- The *34" Extension Hose* (4) connects to the Steam Nozzle and is designed to provide additional freedom to easily reach a variety of spaces. The Jet Nozzle should be connected to the male end of the Extension Hose in order to safely focus the flow of steam.
- The *3" Scraper* (5) connects to the Steam Nozzle and is designed to help scrape and remove baked on food from ovens or other hard to remove materials.
- The *Storage Bag* (6) is provided to store all attachments neatly in one convenient bag.
- The *Fill Cup* (7) is used to fill the reservoir without spills.
- The *2.5" Round Scrub Pad* (8) connects to the Jet Nozzle and is designed to scrub tough dirt and scuffs from surfaces.
- The *1.5" Nylon Utility Brush* (9) connects to the Jet Nozzle and is designed for scrubbing especially tough stains. It is ideal for use on many surfaces around the home, including carpet, ceramic tile, grouting, and more.
- The *1.5" Brass Utility Brush* (10) connects to the Jet Nozzle and is designed for scrubbing especially tough stains. It is perfect for use on BBQ grills, oven racks, automobile engines, shop tools and other hard metal surfaces.

STEAM CLEANING ACCESSORIES

WARNING: Do not connect accessories while unit is emitting steam.

JET NOZZLE / SCRAPER / EXTENSION HOSE / TRIANGLE BRUSH

1. Select one of the four accessories (Jet Nozzle shown as example) and push onto the Steam Nozzle (A).
2. Rotate accessory until the yellow lock/release button snaps into the accessory hole (B).

NOTE: The Jet Nozzle, Scraper and Triangle Brush can be connected to the end of an Extension Hose for reaching high or difficult spots. Connect the Extension Hose, then connect your desired accessory in the same way as you would normally connect to the Jet Nozzle.

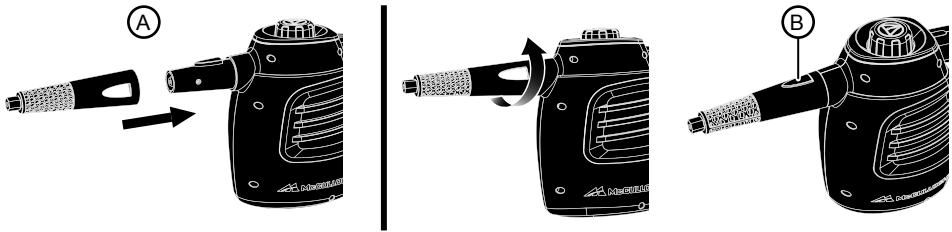

UTILITY BRUSHES / SCRUB PAD

NOTE: These accessories connect to the Jet Nozzle, not the Steam Nozzle.

1. Firmly press accessory onto tip of Jet Nozzle. Press it on as far as possible to prevent steam leakage (See figure 1).
2. To remove Utility Brush, simply grip it firmly and pull it off Jet Nozzle.

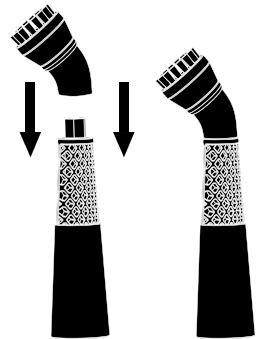

FIGURE 1

LARGE BRUSH

NOTE: Large Brush connects to the Triangle Brush, not the Jet Nozzle.

1. Place Large Brush over the Triangle Brush, and firmly press it on to the Triangle Brush until it snaps into place (See figure 2).
2. To remove Large Brush, simply grip it firmly and pull it off of the Triangle Brush.

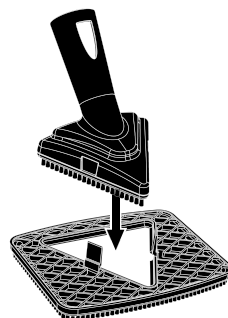

FIGURE 2

ORDERING ACCESSORIES & PARTS

Replacement accessories and parts for your Handheld Steam Cleaner (model MC1230) may be ordered through our Website:

www.mccullochsteam.com

You may also contact Consumer Service directly:

consumerservice@mccullochsteam.com or 1-800-711-6617

Jet Nozzle	Dirt, Grease, Grime, Cracks and Crevices, Golf Clubs, Tread of Running Shoes
Triangle Brush	Corners on Countertops, Bathtubs, Floors
Large Brush	Floors, Grout
Scraper	Baked on Food, Grime, Grease, Stove Tops, Ovens
Round Scrub Pad	Countertops, Bathtubs, Sinks, Refrigerators, Ovens, Slate
Nylon Utility Brush	Ovens, Stove Tops, Faucet Fixtures, Microwaves, Sports Equipment, Tile, Grout, Refrigerators, Toys, Door Knobs, Showers, Bathtubs, Changing Tables
Brass Utility Brush	BBQ Grills, Oven Wire Racks

NOTE: Before cleaning electrical appliances, check and follow appliance manufacturer's cleaning guidelines. Never apply to electrical parts.

NOTE: Some delicate surfaces, such as painted wood or stainless steel may be scratched or damaged by the bristle of the brushes, especially the Brass Utility Brush. Use careful judgment when deciding what surface to clean with any of the brushes. If you are unsure if a surface will be damaged, it is recommended that you test a small inconspicuous spot before proceeding.

FILLING THE RESERVOIR

1. Place Handheld Steam Cleaner on a flat, level surface.
2. Make sure On/Off Switch is turned to "Off" and grounded power cord is unplugged from electrical outlet.



If unit has been in use, always use the following safety precautions before removing the Reservoir Cap to add water:

- Allow unit to cool for 20 minutes.
- Press and hold Steam Trigger to release **ALL** remaining steam.

WARNING: Failure to follow these precautions may result in burns from escaping steam when the Reservoir Cap is removed.

3. Cautiously unscrew and remove Reservoir Cap.
4. Drain any water remaining inside Reservoir.

NOTE: Reservoir should be emptied after each use – this will help minimize mineral build-up and prevent over-filling.

5. Fill the Fill Cup to maximum fill line (6 oz. / 177 ml.) with water.

NOTE: In order to significantly reduce mineral build-up and prolong the life of your Handheld Steam Cleaner, use of distilled or de-mineralized water in the unit is highly recommended. Refer to Page 13 for more information about mineral build-up.

6. Carefully pour water from Fill Cup into Reservoir.

WARNING: Caution should always be used when pouring water into the Reservoir. Do not look directly down into fill hole when filling. Keep your free hand and any children or pets at a safe distance.

7. Replace Reservoir Cap, ensuring that it is screwed on tightly to prevent hot steam from escaping and causing injury.

GENERAL OPERATION

NOTE: Be sure that Reservoir has been filled and that all desired accessories are connected before following these steps.

1. For first time use, remove protective plastic cover from electrical plug. Plug power cord into a electrical outlet.
2. Press On/Off Switch to “On” position. Steam Indicator Light will illuminate Red. Once unit is ready to steam, Steam Indicator Light will turn Green. During use, the light may turn Red, indicating the steamer is recovering the necessary pressure. Unit can be used at a lower pressure.
3. Direct Nozzle (and any connected accessory) towards surface you desire to steam, and press Steam Trigger.

CAUTION: Always be sure that Nozzle and any accessory are pointed in a safe direction (away from yourself, other people, pets, and plants) before pressing Steam Trigger.

4. Keep Steam Trigger pressed for a continuous flow of steam. You may also hold the Steam Trigger, then push the Steam Trigger Lock to lock it down. This will allow a continuous flow of steam without need of holding the Steam Trigger down manually.
5. Using a back-and-forth motion over the area you are steaming will further enhance the cleaning process. Wipe steamed areas with a clean cloth to remove loosened dirt and grime. Wiping the area while it is still wet is recommended, but use caution when wiping surfaces such as metal that may still be hot.
6. Once steaming tasks are complete, turn the unit “Off” and unplug. Follow steps under Proper Storage procedure on Page 13 of this manual.

PROPER STORAGE

Preparing your Handheld Steam Cleaner for storage is quick and simple. When you have finished your steaming tasks, follow the steps listed below.

1. Turn unit "Off" and unplug power cord.
2. Allow unit to completely cool (at least 30 minutes).
3. Press and hold Steam Trigger to release all remaining steam.
4. Remove all accessories from unit.
5. Carefully remove Reservoir Cap.
6. Drain any remaining water from Reservoir into a sink or tub – this will help to minimize mineral build-up and prevent over-filling during your next use. Replace Reservoir Cap loosely.
7. Store accessories. Accessories can be conveniently stored in the Storage Bag.
8. Store Handheld Steam Cleaner in a cool, dry location.

MINERAL BUILD-UP

A common maintenance need for steam appliances is the removal of build-up caused by high mineral content in many municipal water supplies. This mineral build-up may limit the effectiveness and reduce the life of your Handheld Steam Cleaner.

The best way to minimize mineral build-up is to use distilled or de-mineralized water when using your Handheld Steam Cleaner. If you are unable to use distilled water, it is recommended that the following procedure be followed monthly to remove any mineral build-up:

1. Turn unit "Off" and unplug power cord.
2. Allow unit to completely cool (at least 30 minutes).
3. Press and hold Steam Trigger to release all remaining steam.
4. Remove all accessories from unit.
5. Carefully remove Reservoir Cap.
6. Drain water from Reservoir into a sink or tub.
7. Using Measuring Cup, measure of 6 oz. (177 ml.) vinegar.
8. Slowly pour vinegar into Reservoir.
9. Allow to stand for 40 minutes.
10. Drain vinegar from Reservoir.
11. Rinse Reservoir with fresh water, drain and repeat until vinegar odor dissipates.
12. Replace Reservoir Cap.

PROBLEM	POSSIBLE CAUSE	SOLUTION
Unit fails to heat up.	Unit is not plugged in. Household circuit breaker / ground fault interrupter has tripped or blown a fuse.	Plug power cord into electrical outlet. Reset circuit breaker / ground fault interrupter, or replace fuse. If you need assistance, contact a licensed electrician.
	Unit is damaged or otherwise in need of repair.	Immediately cease usage and unplug. Contact Consumer Service for further assistance.
	Reservoir is empty.	Refer to Filling The Reservoir procedure.
	Mineral build-up in unit.	Refer to Mineral Build-up section for cleaning procedure.
Steam output is weak or intermittent.	Water level in Reservoir is running low.	Refer to Filling The Reservoir procedure.
	Mineral build-up in unit.	Refer to Mineral Build-up section for cleaning procedure.
Excessive amount of water in steam. NOTE: Unit produces wet steam – it is normal for steam to contain some amount of water.	Water condensation in Extension Hose.	Point nozzle towards sink, tub or ground and shake while pressing Steam Trigger. Continue until excess water is released.
	Reservoir has been overfilled.	Filling Reservoir with more than 6 oz. (177 ml.) of water interferes with steam production, resulting in water condensation in steam. Always use included Fill Cup to fill unit with correct amount of water.
Accessories do not stay firmly connected to Steam Nozzle.	Accessories not properly installed.	Check to make sure that accessories are properly connected, per procedures.

McCulloch is manufactured by Vornado Air LLC under license from Husqvarna AB (publ). McCulloch warrants to the original consumer or purchaser this McCulloch ("Product") is free from defects in material or workmanship for a period of two (2) years from the date of purchase. If any such defect is discovered within the warranty period, Vornado, at its discretion, will repair or replace the Product at no cost.

For warranty service: Call 1-800-711-6617 or email consumerservice@mccullochsteam.com to obtain a Return Authorization ("RA"). Please have or include your Product's model number and serial number, as well as your name, address, city, state, Zip code, email, and phone number when contacting Vornado for warranty service. To file a contactless warranty claim, visit www.mccullochsteam.com/contact

This warranty does not apply to defects resulting from abuse of the Product, modification, alteration, mishandling, improper maintenance, commercial use or repair or service of the Product by anyone other than Vornado; damages which occur in shipment or are attributed to acts of God. Improper product use, which includes using an external device that alters or converts the voltage or frequency of electricity, or shipping a Vornado product to a country not intended for use will void all warranties. Any unauthorized product modification, repair by unauthorized repair center or use of non-approved replacement parts is not recommended and any consequences will not be covered by support services or product warranties.

The product warranty will be honored only on models that are being used in the country intended. REPAIR OR REPLACEMENT AS PROVIDED UNDER THIS WARRANTY IS THE EXCLUSIVE REMEDY OF THE CONSUMER. VORNADO SHALL NOT BE LIABLE FOR ANY INCIDENTAL OR CONSEQUENTIAL DAMAGES FOR BREACH OF ANY EXPRESS OR IMPLIED WARRANTY ON THIS PRODUCT. EXCEPT TO THE EXTENT PROHIBITED BY APPLICABLE LAW, ANY IMPLIED WARRANTY OF MERCHANTABILITY OR FITNESS FOR A PARTICULAR PURPOSE ON THIS PRODUCT IS LIMITED IN DURATION TO THE DURATION OF THIS WARRANTY. Some states do not allow the exclusion or limitation of incidental or consequential damages, or allow limitations on how long an implied warranty lasts, so the above limitations or exclusions may not apply to you. This warranty gives you specific legal rights, and you may have other rights that vary from state to state. The manufacturer assumes no responsibility for damage or injury caused by failure to follow these instructions, improper product use or unauthorized product modifications. Any such actions will invalidate the product warranty.

All company names and product names are trademarks of their respective owners. ©All rights reserved. All technical information, data and instructions for the installation, connection and operation contained in these instructions for use correspond to the latest available information at time of printing. The contents of this manual may differ slightly from the actual product. Observe any additional supplements.

© 2025 Vornado Air, LLC. Andover, KS 67002, U.S. Specifications subject to change without notice. Manufactured by Vornado Air LLC under license from Husqvarna AB (publ). Manufactured in China.



review this product online

www.mccullochsteam.com/reviews

Manufactured by Vornado Air LLC under license from Husqvarna AB (publ).

For more information on other McCulloch products,
visit www.mcculloch.com

For questions, or comments or warranty information,
call 1-800-711-6617 or visit www.mccullochsteam.com